

Tremco CPG UK Ltd

Coupland Road
Hindley Green
Wigan
Lancashire WN2 4HT

Tel: 01942 251400

e-mail: hello@tremcocpg.com

website: www.tremcocpg.eu



Agrément Certificate

12/4891

Product Sheet 7 Issue 1

CPG UK WINDOW AND DOOR PRODUCTS

ILLBRUCK TP610 ILLMOD COMPRI SEALING TAPES

This Agrément Certificate Product Sheet⁽¹⁾ relates to illbruck TP610 illmod Compri Sealing Tapes, a range of acrylic, UV-stabilised, resin-impregnated foam based sealing tapes, for use in movement joints and perimeter sealing of windows and doors above ground level to provide a weathertight seal.

(1) Hereinafter referred to as 'Certificate'.

The assessment includes

Product factors:

- compliance with Building Regulations
- compliance with additional regulatory or non-regulatory information where applicable
- evaluation against technical specifications
- assessment criteria and technical investigations
- uses and design considerations

Process factors:

- compliance with Scheme requirements
- installation, delivery, handling and storage
- production and quality controls
- maintenance and repair

Ongoing contractual Scheme elements†:

- regular assessment of production
- formal 3-yearly review



KEY FACTORS ASSESSED

- Section 1. Mechanical resistance and stability
- Section 2. Safety in case of fire
- Section 3. Hygiene, health and the environment
- Section 4. Safety and accessibility in use
- Section 5. Protection against noise
- Section 6. Energy economy and heat retention
- Section 7. Sustainable use of natural resources
- Section 8. Durability

The BBA has awarded this Certificate to the company named above for the products described herein. These products have been assessed by the BBA as being fit for their intended use provided they are installed, used and maintained as set out in this Certificate.

On behalf of the British Board of Agrément

Date of issue: 10 January 2024

Hardy Giesler
Chief Executive Officer

This BBA Agrément Certificate is issued under the BBA's Inspection Body accreditation to ISO/IEC 17020. Sections marked with † are not issued under accreditation.

The BBA is a UKAS accredited Inspection Body (No. 4345), Certification Body (No. 0113) and Testing Laboratory (No. 0357).

Readers MUST check that this is the latest issue of this Agrément Certificate by either referring to the BBA website or contacting the BBA directly.

The Certificate should be read in full as it may be misleading to read clauses in isolation.

Any photographs are for illustrative purposes only, do not constitute advice and should not be relied upon.

British Board of Agrément

1st Floor, Building 3, Hatters Lane
Croxley Park, Watford
Herts WD18 8YG

©2024

tel: 01923 665300
clientservices@bbacerts.co.uk
www.bbacerts.co.uk

SUMMARY OF ASSESSMENT AND COMPLIANCE

This section provides a summary of the assessment conclusions; readers should refer to the later sections of this Certificate for information about the assessments carried out.

Compliance with Regulations

Having assessed the key factors, the opinion of the BBA is that illbruck TP610 illmod Compri Sealing Tapes, if installed, used and maintained in accordance with this Certificate, can satisfy or contribute to satisfying the relevant requirements of the following Building Regulations:



The Building Regulations 2010 (England and Wales) (as amended)

Requirement:	C2(b)	Resistance to moisture
Comment:		The products will contribute to satisfying this Requirement. See section 3 of this Certificate.
Requirement:	7(1)	Materials and workmanship
Comment:		The products are acceptable. See sections 8 and 9 of this Certificate.
Requirement:	L1(a)(i)	Conservation of fuel and power
Comment:		The products can contribute to minimising heat loss at lintels, jambs and sills. See section 6 of this Certificate.
Regulation:	25B	Nearly zero-energy requirements for new buildings
Regulation:	26	CO₂ emission rates for new buildings
Regulation:	26A	Fabric energy efficiency rates for new dwellings (applicable to England only)
Regulation:	26A	Primary energy consumption rates for new buildings (applicable to Wales only)
Regulation:	26B	Fabric performance values for new dwellings (applicable to Wales only)
Regulation:	26C	Target primary energy rates for new buildings (applicable to England only)
Regulation:	26C	Minimum energy efficiency rating (applicable to Wales only)
Comment:		The products can contribute to satisfying these Regulations. See section 6 of this Certificate.



The Building (Scotland) Regulations 2004 (as amended)

Regulation:	8(1)(2)	Fitness and durability of materials and workmanship
Comment:		The use of the products can contribute to satisfying the requirements of this Regulation. See sections 8 and 9 of this Certificate.
Regulation:	9	Building standards – construction
Standard:	3.10	Precipitation
Comment:		The products will contribute to satisfying the requirements of this Standard, with reference to clause 3.10.1 ⁽¹⁾⁽²⁾ . See section 3 of this Certificate.
Standard:	6.1(b)(c)(d)	Energy demand and carbon dioxide emissions
Standard:	6.2	Building insulation envelope
Comment:		The products can contribute to minimising heat loss at lintels, jambs and sills, with reference to clauses 6.1.2 ⁽¹⁾ , 6.1.4 ⁽²⁾ , 6.2.4 ⁽¹⁾ and 6.2.5 ⁽²⁾ of these Standards. See section 6 of this Certificate.
Standard:	7.1(a)(b)	Statement of sustainability
Comment:		The products can contribute to satisfying the relevant requirements of Regulation 9, Standards 1 to 6, and therefore will contribute to a construction meeting a bronze level of sustainability as defined in this Standard.

Regulation:	12	Building standards – conversions
Comment:		Comments given for the products under Regulation 9, Standards 1 to 6, also apply to this Regulation, with reference to clause 0.12.1 ⁽¹⁾⁽²⁾ and Schedule 6 ⁽¹⁾⁽²⁾ .
		(1) Technical Handbook (Domestic). (2) Technical Handbook (Non-Domestic).



The Building Regulations (Northern Ireland) 2012 (as amended)

Regulation:	23(1)(a)(i)	Fitness of materials and workmanship
Comment:	(iii)(b)(i)	The products are acceptable. See sections 8 and 9 of this Certificate.
Regulation:	28(b)	Resistance to moisture and weather
Comment:		The products can contribute to satisfying this Regulation. See section 3 of this Certificate.
Regulation:	39(a)(i)	Conservation measure
Regulation:	40(2)	Target carbon dioxide emission rate
Regulation:	43(1)(2)	Renovation of thermal elements
Regulation:	43B	Nearly zero-energy requirements for new buildings
Comment:		The products can contribute to minimising heat loss at lintels, jambs and sills. See section 6 of this Certificate.

Additional Information

NHBC Standards 2024

In the opinion of the BBA, illbruck TP610 illmod Compri Sealing Tapes, if installed, used and maintained in accordance with this Certificate, can satisfy or contribute to satisfying the relevant requirements in relation to *NHBC Standards*, Chapters 6.7 *Doors, windows and glazing* and 6.9 *Curtain walling and cladding*.

In Scotland and Northern Ireland and other areas of very severe exposure, 'check' reveals must be used, and an appropriate sealant applied between the window frame and the structure.

Fulfilment of Requirements

The BBA has judged illbruck TP610 illmod Compri Sealing Tapes to be satisfactory for use as described in this Certificate. The products have been assessed in movement joints and perimeter sealing of windows and doors above ground level to provide a weathertight seal.

ASSESSMENT

Product description and intended use

The Certificate holder provided the following description for the products under assessment. illbruck TP610 illmod Compri Sealing Tapes consist of an acrylic, UV-stabilised, resin-impregnated polyurethane foam, available in anthracite grey. One side of the strip has a self-adhesive film to aid initial location. The adhesive layer is protected by a silicone release paper. The dimensions of the tapes are given in Table 1.

Table 1 Tape dimensions

Tape size/code no ⁽¹⁾	Suitable joint depth (mm) ⁽²⁾	Suitable joint width (mm) ⁽³⁾
10/1-2	10	1-2
10/2-4	10	2-4
15/3-6	15	3-6
15/4-10	15	4-10
20/3-6	20	3-6
20/5-12	20	5-12
25/5-12	25	5-12
25/7-16	25	7-16
30/9-20	30	9-20
40/7-16	40	7-16

(1) Other dimensions are available on request.

(2) Tape width (joint depth must be 2 to 3 mm greater to allow for tape setback).

(3) Tape thickness (joint width).

Applications

The products are intended for use on the following substrates:

- wood
- metal (iron, steel, galvanised steel, aluminium and copper)
- concrete and aerated concrete
- masonry
- PVC-U
- Polymethyl methacrylate (PMMA) glazing.

Product assessment – key factors

The products were assessed for the following key factors, and the outcome of the assessment is shown below. Conclusions relating to the Building Regulations apply to the whole of the UK unless otherwise stated.

1 Mechanical resistance and stability

Not applicable.

2 Safety in case of fire

Data were assessed for the following characteristic.

2.1 Reaction to fire

2.1.1 The Certificate holder has not declared a reaction to fire classification to BS EN 13501-1 : 2018 for the products.

2.1.2 On the basis of data assessed, the use of the products is unrestricted in terms of height and distance from a relevant boundary by the documents supporting the national Building Regulations.

2.1.3 Cavity barriers must be used to satisfy the requirements of the documents supporting the national Building Regulations.

3 Hygiene, health and the environment

Data were assessed for the following characteristics.

3.1 Weathertightness

3.1.1 Results of weathertightness tests are given in Table 2.

Table 2 Results of weathertightness tests

Product assessed	Assessment method	Requirement	Result
illbruck TP610 illmod Compri Sealing Tapes	Resistance to driving rain to DIN EN 1027 : 2000	≥ 600 Pa	Pass
illbruck TP610 illmod Compri Sealing Tapes	Watertightness of joints against driving rain to DIN EN 1027 : 2000	≥ 600 Pa	Pass

3.1.2 On the basis of data assessed, the products will resist the passage of water, wind-driven rain and dust into the inside of a building and so satisfy the relevant requirements of the national Building Regulations.

3.1.3 On the basis of data assessed, the products satisfy the Class 9A requirements of BS EN 12208 : 2000.

3.2 Water vapour permeability

3.2.1 The result of a water vapour permeability test is given in Table 3.

Table 3 Result of a water vapour permeability test

Product assessed	Assessment method	Requirement	Result
illbruck TP610 illmod Compri Sealing Tape 16 mm tape width (joint depth), 7 to 16 mm (suitable joint width), installed in 12 mm wide joint	Diffusion-equivalent air layer thickness (s_d) to DIN EN ISO 12572 : 2016 50% relative humidity at 23°C	Value achieved	0.063 m

3.2.2 The value given in Table 3 may be used as part of a condensation risk assessment in accordance with BS 5250 : 2021.

3.3 Resistance to mechanical damage

3.3.1 Results of resistance to mechanical damage tests are given in Table 4.

Table 4 Results of resistance to mechanical damage tests

Product assessed	Assessment method	Requirement	Result
illbruck TP610 illmod Compri Sealing Tapes	Tensile strength to BS EN ISO 1798 : 2008	Value achieved	91 N·(50 mm) ⁻¹
illbruck TP610 illmod Compri Sealing Tapes	Elongation to BS EN ISO 1798 : 2008	Value achieved	106%

3.3.2 On the basis of data assessed, the products are suitably robust and will not be damaged during installation provided reasonable care is taken.

4 Safety and accessibility in use

Not applicable.

5 Protection against noise

Not applicable.

6 Energy economy and heat retention

Data were assessed for the following characteristic.

6.1 Airtightness

6.1.1 The result of an airtightness test is given in Table 5.

Table 5 Result of an airtightness test

Product assessed	Assessment method	Requirement	Result
illbruck TP610 illmod Compri Sealing Tapes	Air permeability to DIN EN 12114 : 2000	$< 1.0 \text{ m}^3 \cdot \text{h}^{-1} \cdot \text{m}^{-1} \cdot (\text{daPa})^{-2/3}$	Pass

6.1.2 On the basis of data assessed, the products are air barriers and, when installed correctly, can contribute to junctions minimising the heat loss by unplanned air infiltration. The air infiltration classification according to BS EN 12207 : 2016 for suitable windows used in combination with the products will be at least Class 4. Guidance in this respect is found in the documents supporting the national Building Regulations.

7 Sustainable use of natural resources

Not applicable.

8 Durability

8.1 The potential mechanisms for degradation and the known performance characteristics of the materials in the products were assessed.

8.2 Specific test data were assessed as given in Table 6.

Table 6 Results of durability tests

Product assessed	Assessment method	Requirement	Result
illbruck TP610 illmod Compri Sealing Tapes	Tensile strength to BS EN ISO 1798 : 2008 after heat ageing at 80°C for 56 days	No significant deterioration	Pass
illbruck TP610 illmod Compri Sealing Tapes	Elongation to BS EN ISO 1798 : 2008 after heat ageing at 80°C for 56 days	No significant deterioration	Pass
illbruck TP610 illmod Compri Sealing Tapes	Low temperature bending at 5°C to a BBA Method	No visual tears or cracks	Pass
illbruck TP610 illmod Compri Sealing Tapes	Compression set to BS EN ISO 1856 : 2018 (after 75% compression)	Value achieved	-5.61%
illbruck TP610 illmod Compri Sealing Tapes	Resistance to thermal shock to DIN 18542 : 8.6 : 2020 (-20 to 80°C)	No changes to the contact face or to the direct edge of the multifunction sealing tape	Pass
illbruck TP610 illmod Compri Sealing Tapes	Light resistance and resistance to moisture penetration to DIN 18542 : 8.7 : 2020	No changes to the contact face or to the direct edge of the multifunction sealing tape	Pass
illbruck TP610 illmod Compri Sealing Tapes	Compatibility with adjoining building materials (concrete, facing brick, sand-lime brick, spruce wood with water based coating, spruce wood with non-opaque coating and white PVC) to DIN 18542 : 8.8 : 2020	No changes to the contact face or to the direct edge of the multifunction sealing tape	Pass

8.3 Service life

Under normal service conditions, the products will have a life of at least 20 years, provided they are designed, installed and maintained in accordance with this Certificate and the Certificate holder's instructions.

Information provided by the Certificate holder was assessed for the following factors:

9 Design, installation, workmanship and maintenance

9.1 Design

9.1.1 The design process was assessed by the BBA, and the following requirements apply in order to satisfy the performance specified in this Certificate.

9.1.2 Joints must be designed, and the tapes positioned, to ensure that differential movement between panels does not force the products out of the joint.

9.1.3 When fitted in a joint, the tapes re-expand to fill and seal the joint. To provide a weathertight seal, the optimum final compression is 20% of the fully expanded thickness.

9.1.4 Where particularly wide joints are to be sealed, two or more tapes may be superimposed to achieve the final overall compression of between 20 and 33% of the fully expanded dimension (typical tape sizes for various joint widths are given in Table 1). The Certificate holder can provide advice for a particular application, but such advice is outside the scope of this Certificate.

9.1.5 The products are not designed to withstand a head of water; in these situations, the advice of the Certificate holder must be sought, but such advice is outside the scope of this Certificate.

9.1.6 Examples of indicative joint designs are shown in Figures 1 to 3.

Figure 1 Walls — precast concrete panels

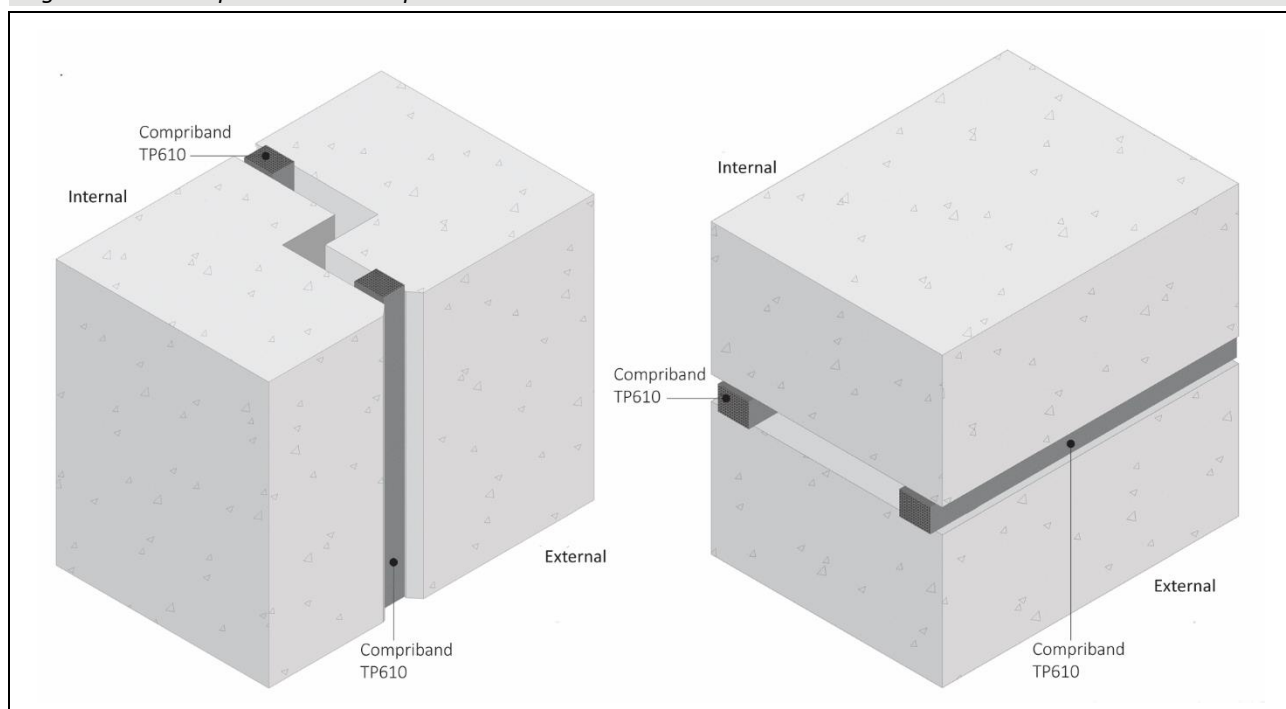

Figure 2 Windows and doors – head, sill and jamb

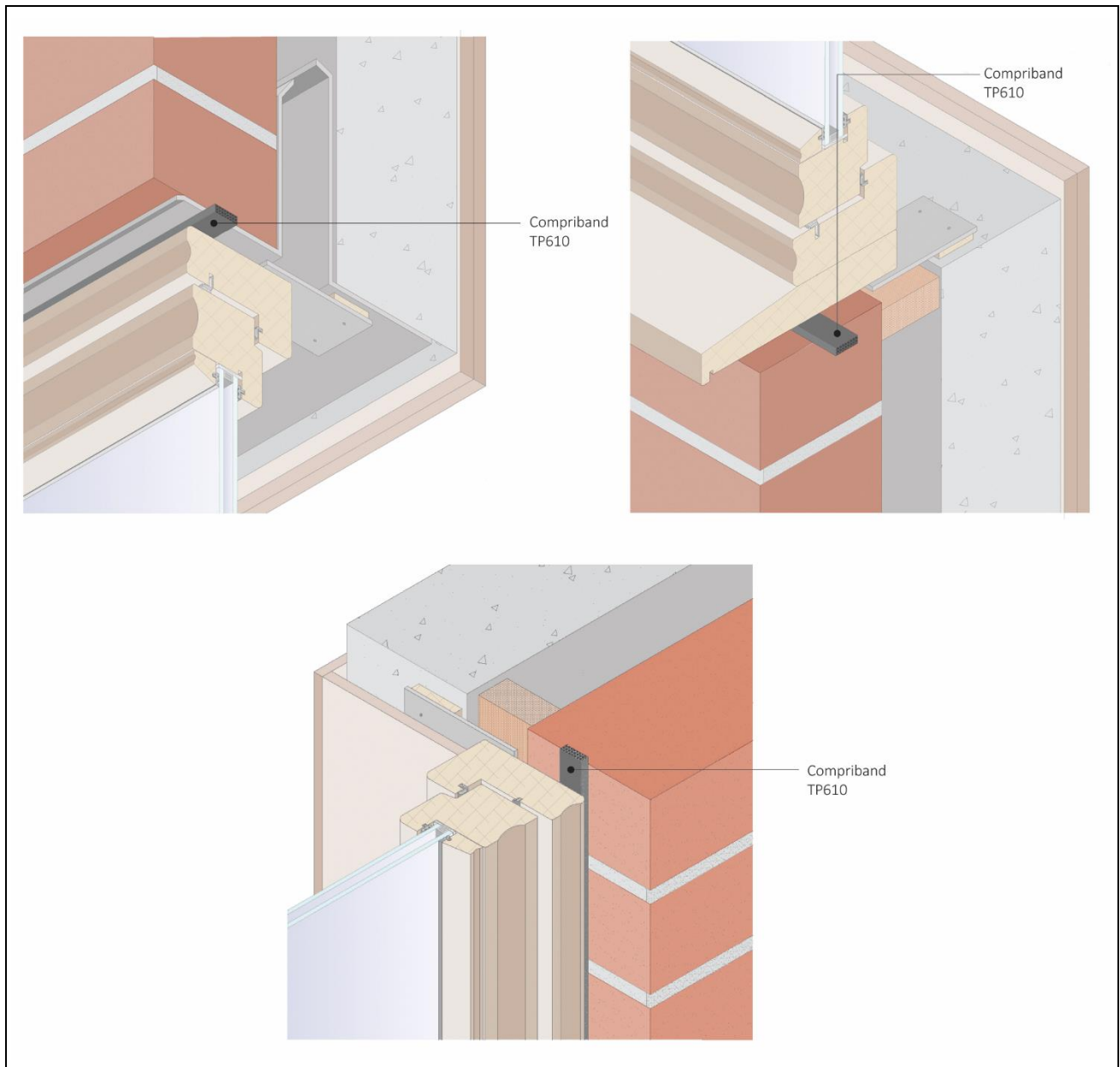
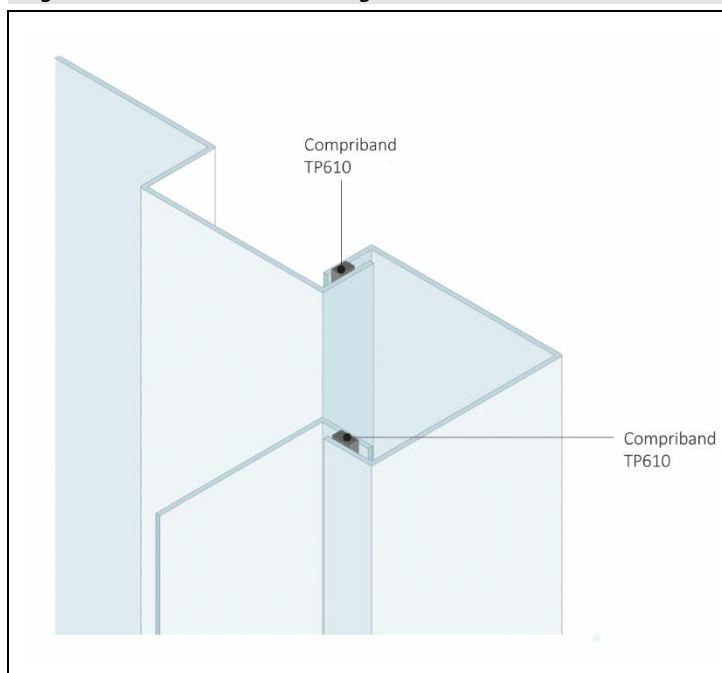

Figure 3 External sheet cladding



9.2 Installation

9.2.1 Installation instructions provided by the Certificate holder were assessed and judged to be appropriate and adequate.

9.2.2 Installation must be carried out in accordance with this Certificate and the Certificate holder's instructions.

9.2.3 Joints must be clean and free from debris, eg dirt or mortar residue likely to obstruct adhesion. The inner surfaces of the joints to be filled must be as smooth as possible. To achieve a perfect seal in masonry, the changes in level at mortar joints must be as small as possible.

9.2.4 The tape will start to re-expand as soon as it is unwound from the roll. The rate of re-expansion is temperature-dependent, and at low ambient temperatures the rate can be increased by the gentle application of heat. At high temperatures, the tapes must be stored in a cool environment prior to use. Approximate expansion rates are shown in Table 7.

Table 7 Approximate expansion rates using 20/3-6 tape

Temperature (°C)	Re-expansion times ⁽¹⁾⁽²⁾
5	24 hours
23	10–120 mins

(1) At temperatures below 0°C, re-expansion will be slow.

(2) Dependent on age of tape at the time of use.

9.2.5 When using the tapes to seal between prefabricated units during construction, the seal must be bonded to the unit already in position. The adjoining unit can then be fitted.

9.2.6 The length of the joint to be sealed must be measured, and an overlap of 20 mm per metre run allowed when the tape is cut to the required length. The silicone release paper must be removed, and the tape positioned in the joint, starting at the end and aligned with a flat-bladed tool and set back 2 to 3 mm from the front face of the joint (see Figure 4).

Figure 4 Installation practices

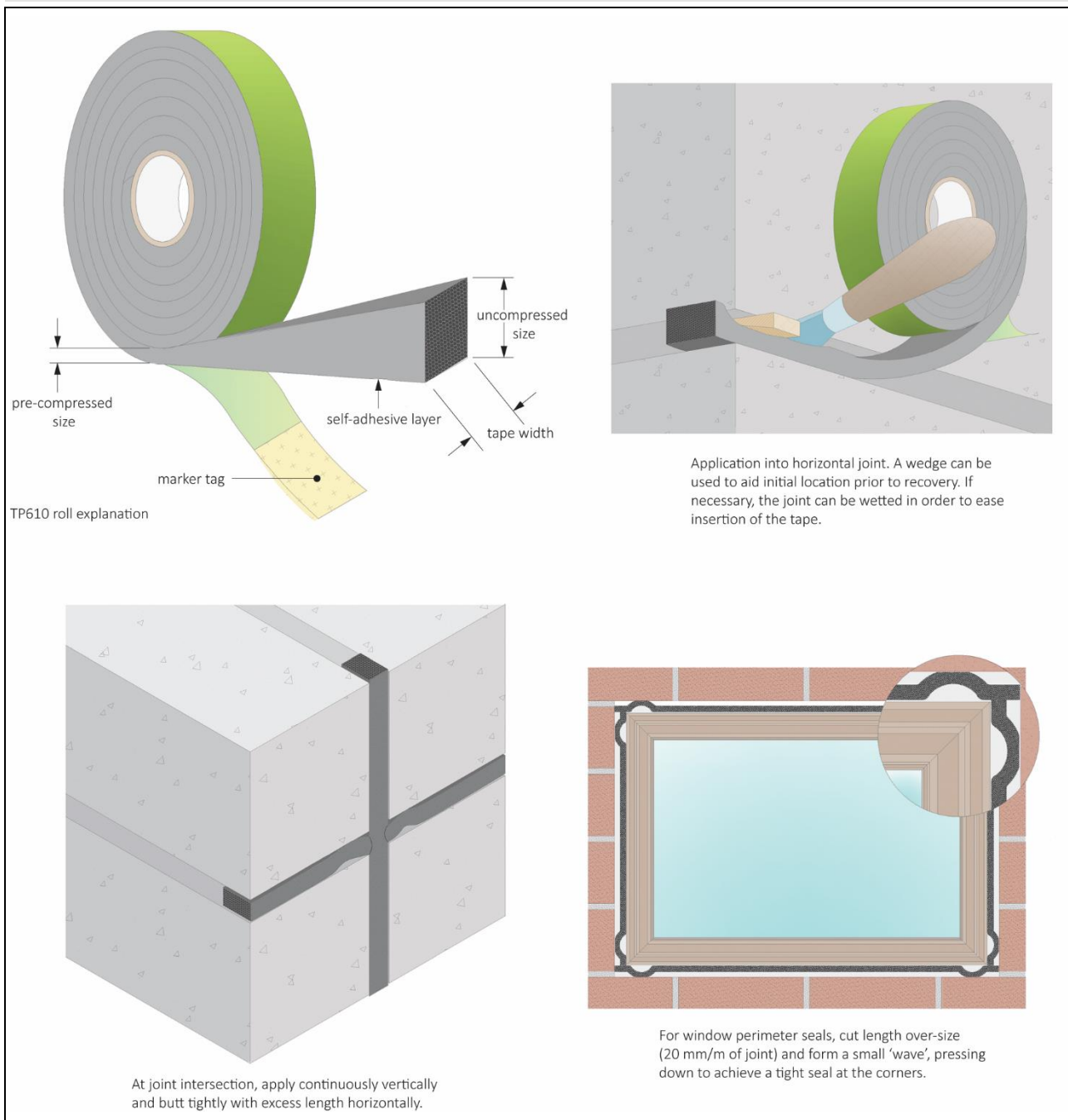

9.3 Workmanship

Practicability of installation was assessed by the BBA and on the basis of the Certificate holder's information. To achieve the performance described in this Certificate, installation of the products must be carried out by a competent general builder or contractor experienced with these types of products.

9.4 Maintenance and repair

9.4.1 Ongoing satisfactory performance of the products in use requires that they are suitably maintained. The guidance provided by the Certificate holder was assessed by the BBA and found to be appropriate and adequate.

9.4.2 Installations must be periodically inspected for damage. Damaged sections of tape must be replaced as soon as possible.

10 Manufacture

10.1 The production processes for the products have been assessed, and provide assurance that the quality controls are satisfactory according to the following factors:

10.1.1 The manufacturer has provided documented information on the materials, processes, testing and control factors.

10.1.2 The quality control operated over batches of incoming materials has been assessed and deemed appropriate and adequate.

10.1.3 The quality control procedures and product testing to be undertaken have been assessed and deemed appropriate and adequate.

10.1.4 The process for management of non-conformities has been assessed and deemed appropriate and adequate.

10.1.5 An audit of each production location was undertaken, and it was confirmed that the production process was in accordance with the documented process, and that equipment has been properly tested and calibrated.

† 10.2 The BBA has undertaken to review the above measures on a regular basis through a surveillance process, to verify that the specifications and quality control operated by the manufacturer are being maintained.

11 Delivery and site handling

11.1 The Certificate holder stated that the products are delivered to site in packaging bearing the product name, Certificate holder's name and dimensions.

11.2 Delivery and site handling must be performed in accordance with the Certificate holder's instructions and this Certificate, including:

11.2.1 The products must be stored horizontally and in their original carton between 1 and 25°C, in dry conditions and away from heat or direct sunlight.

11.2.2 Packaging must be re-sealed between uses to prevent expansion during storage.

ANNEX A – SUPPLEMENTARY INFORMATION †

Supporting information in this Annex is relevant to the product but has not formed part of the material assessed for the Certificate.

Construction (Design and Management) Regulations 2015

Construction (Design and Management) Regulations (Northern Ireland) 2016

Information in this Certificate may assist the client, designer (including Principal Designer) and contractor (including Principal Contractor) to address their obligations under these Regulations.

CLP Regulations

The Certificate holder has taken the responsibility of classifying and labelling the products under the *GB CLP Regulation* and *CLP Regulation (EC) No 1272/2008 - classification, labelling and packaging of substances and mixtures*. Users must refer to the relevant Safety Data Sheet(s).

Management Systems Certification for production

The management system of the manufacturer has been assessed and registered as meeting the requirements of EN ISO 9001 : 2015 by TÜV Rheinland Industrie Service GmbH (Certificate 01 100 4301).

Bibliography

BS 5250 : 2021 *Management of moisture in buildings — Code of practice*

BS EN 12207 : 2016 *Windows and doors — Air permeability — Classification*

BS EN 12208 : 2000 *Windows and door — Watertightness — Classification*

BS EN 13501-1 : 2018 *Fire classification of construction products and building elements — Classification using data from reaction to fire tests*

BS EN ISO 1798 : 2008 *Flexible cellular polymeric materials — Determination of tensile strength and elongation at break*

BS EN ISO 1856 : 2018 *Flexible cellular polymeric materials — Determination of compression set*

DIN 18542 : 2020 *Impregnated sealing tapes made of cellular plastics for sealing of outside wall joints — Requirements and testing*

DIN EN 1027 : 2000 *Windows and doors — Watertightness — Test method*

DIN EN 12114 : 2000 *Thermal performance of buildings — Air permeability of building components and building elements — Laboratory test method*

DIN EN ISO 12572 : 2016 *Hygrothermal performance of building materials and products — Determination of water vapour transmission properties — Cup method*

EN ISO 9001 : 2015 *Quality management systems — Requirements*

Conditions of Certificate

Conditions

1 This Certificate:

- relates only to the product that is named and described on the front page
- is issued only to the company, firm, organisation or person named on the front page – no other company, firm, organisation or person may hold or claim that this Certificate has been issued to them
- is valid only within the UK
- has to be read, considered and used as a whole document – it may be misleading and will be incomplete to be selective
- is copyright of the BBA
- is subject to English Law.

2 Publications, documents, specifications, legislation, regulations, standards and the like referenced in this Certificate are those that were current and/or deemed relevant by the BBA at the date of issue or reissue of this Certificate.

3 This Certificate will be displayed on the BBA website, and the Certificate Holder is entitled to use the Certificate and Certificate logo, provided that the product and its manufacture and/or fabrication, including all related and relevant parts and processes thereof:

- are maintained at or above the levels which have been assessed and found to be satisfactory by the BBA
- continue to be checked as and when deemed appropriate by the BBA under arrangements that it will determine
- are reviewed by the BBA as and when it considers appropriate.

4 The BBA has used due skill, care and diligence in preparing this Certificate, but no warranty is provided.

5 In issuing this Certificate the BBA is not responsible and is excluded from any liability to any company, firm, organisation or person, for any matters arising directly or indirectly from:

- the presence or absence of any patent, intellectual property or similar rights subsisting in the product or any other product
- the right of the Certificate holder to manufacture, supply, install, maintain or market the product
- actual installations of the product, including their nature, design, methods, performance, workmanship and maintenance
- any works and constructions in which the product is installed, including their nature, design, methods, performance, workmanship and maintenance
- any loss or damage, including personal injury, howsoever caused by the product, including its manufacture, supply, installation, use, maintenance and removal
- any claims by the manufacturer relating to UKCA marking and CE marking.

6 Any information relating to the manufacture, supply, installation, use, maintenance and removal of this product which is contained or referred to in this Certificate is the minimum required to be met when the product is manufactured, supplied, installed, used, maintained and removed. It does not purport in any way to restate the requirements of the Health and Safety at Work etc. Act 1974, or of any other statutory, common law or other duty which may exist at the date of issue or reissue of this Certificate; nor is conformity with such information to be taken as satisfying the requirements of the 1974 Act or of any statutory, common law or other duty of care.

British Board of Agrément

1st Floor, Building 3, Hatters Lane
Croxley Park, Watford
Herts WD18 8YG

©2024

tel: 01923 665300
clientservices@bbacerts.co.uk
www.bbacerts.co.uk